

FAG

6207

Deep groove ball bearing

Schaeffler ID:
0167202020000Deep groove ball bearing 62, single row,
steel sheet metal cage

Technical information

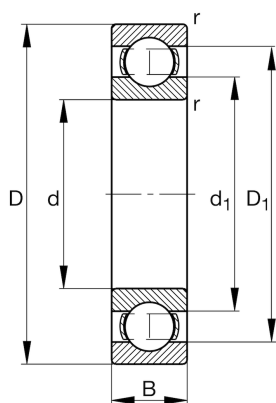
**Main Dimensions & Performance Data**

d	35 mm	Bore diameter
D	72 mm	Outside diameter
B	17 mm	Width
C_r	27,500 N	Basic dynamic load rating, radial
C_{0r}	15,300 N	Basic static load rating, radial
C_{ur}	950 N	Fatigue load limit, radial
n_G	13,800 1/min	Limiting speed
n_{gr}	10,400 1/min	Reference speed
	0.282 kg	Weight

Dimensions

r_{min}	1.1 mm	Minimum chamfer dimension
D_1	60.7 mm	Shoulder diameter outer ring
d_1	47.2 mm	Shoulder diameter inner ring

Mounting dimensions

$d_{a min}$	42 mm	Minimum diameter shaft shoulder
$D_{a max}$	65 mm	Maximum diameter of housing shoulder
$r_{a max}$	1.1 mm	Maximum fillet radius

Calculation factors

f_0	13.8	Calculation factor
-------	------	--------------------

Temperature range

T_{min}	-30 °C	Operating temperature min.
T_{max}	120 °C	Operating temperature max.